

hpl/
mdf/
aluminium grid/
polystyrene EPS/

| | | |
|-----------------------------|-----------------------------|-----------------------------|
| 1. THERMAL PANEL t = 24 mm | K- Transmission Coefficient | U= 1.79 W/m ² K |
| 2. THERMAL PANEL t = 40 mm | K- Transmission Coefficient | U= 1.047 W/m ² K |
| 3. THERMAL PANEL t = 80 mm | K- Transmission Coefficient | U= 0.444 W/m ² K |
| 4. THERMAL PANEL t = 120 mm | K- Transmission Coefficient | U= 0.292 W/m ² K |

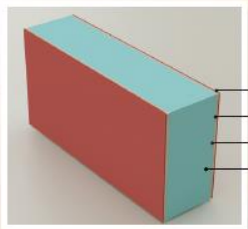

hpl/
mdf/
aluminium grid/
polystyrene XPS/

| | | |
|-----------------------------|-----------------------------|-----------------------------|
| 1. THERMAL PANEL t = 24 mm | K- Transmission Coefficient | U= 1.95 W/m ² K |
| 2. THERMAL PANEL t = 40 mm | K- Transmission Coefficient | U= 1.047 W/m ² K |
| 3. THERMAL PANEL t = 80 mm | K- Transmission Coefficient | U= 0.484 W/m ² K |
| 4. THERMAL PANEL t = 120 mm | K- Transmission Coefficient | U= 0.314 W/m ² K |

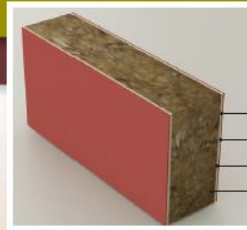

hpl/
mdf/
aluminium grid/
rock wool/

| | | |
|-----------------------------|-----------------------------|-----------------------------|
| 1. THERMAL PANEL t = 24 mm | K- Transmission Coefficient | U= 1.9 W/m ² K |
| 2. THERMAL PANEL t = 40 mm | K- Transmission Coefficient | U= 1.028 W/m ² K |
| 3. THERMAL PANEL t = 80 mm | K- Transmission Coefficient | U= 0.47 W/m ² K |
| 4. THERMAL PANEL t = 120 mm | K- Transmission Coefficient | U= 0.306 W/m ² K |

HPL 0.9 mm/MDF 2.7 mm + ROCK WOOL + HPL 0.9 mm/MDF 2.7 mm

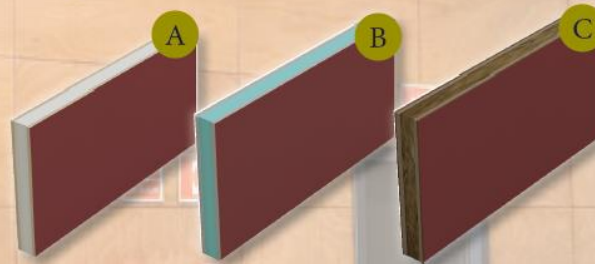

INTERNAL WALL PANELS



HPL PANELS

INTERNAL WALL PANELS

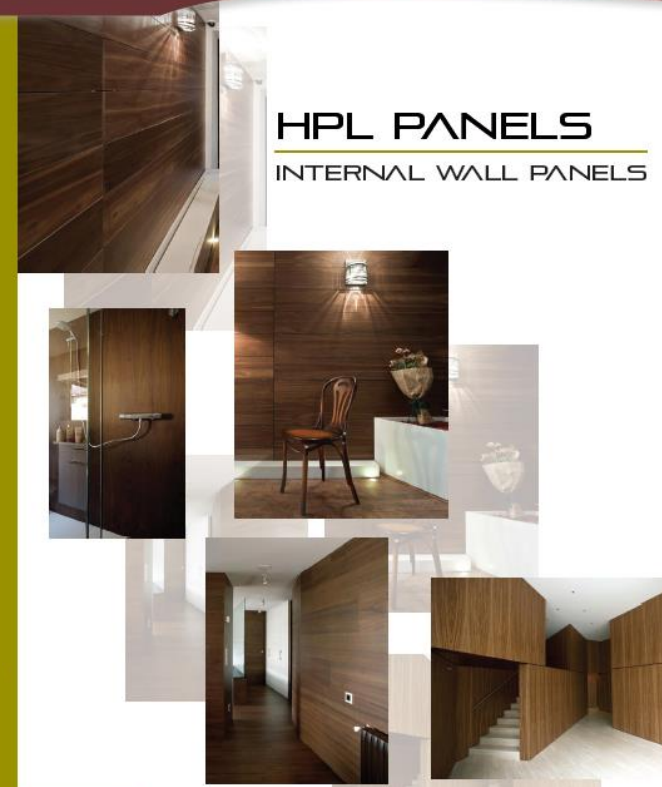

Total thickness of panel:

24 mm / 40 mm / 60 mm / 80 mm / 100 mm / 120 mm

and other dimensions based on clients request.



ALUMINIUM PROFILES FOR THE UNION PANELS



Code : 1927

Code : 2000

Code : 2174



Code : 2455

Code : 2483

Code : 2533

ALUMINIUM PROFILES- WALL SYSTEM



Code : 2484

Code : 2485

Code : 2700



Code : 2496

Code : 2705

Code : 2706



Code : 2766

Code : 2702

Code : 2495



HPL PANEL are:

- stretch ad moisture resistance
- easy to clean and durable
- eco - friendly and durable
- high abrasive resistance
- amazing designs



Usage:

- showroom
- office partition
- restaurant
- home
- stores
- kitchen
- table
- interior partition

